

PAB1 and PABS1 Breathers



PAB1



PABS1

Specifications:

- Max flow rate 10 SCFM / 80 GPM
- Durable synthetic material (Nylon 6)
- 3 μ m filtration rating
- Buna N O-Ring
- Optional dipstick (PAB1 only, contact factory)
- Optional customer logo (contact factory)
- Optional relief valve for pressurized reservoir
- Integrated anti-splash insert
- -22° to 212°F (-30° to 100°C)
- Phenolic resin impregnated filter element

Dimensions:

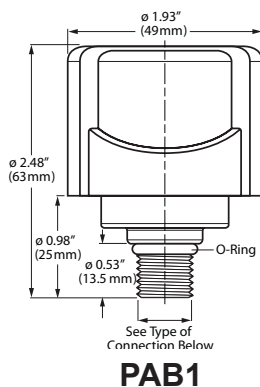

Dimensions:

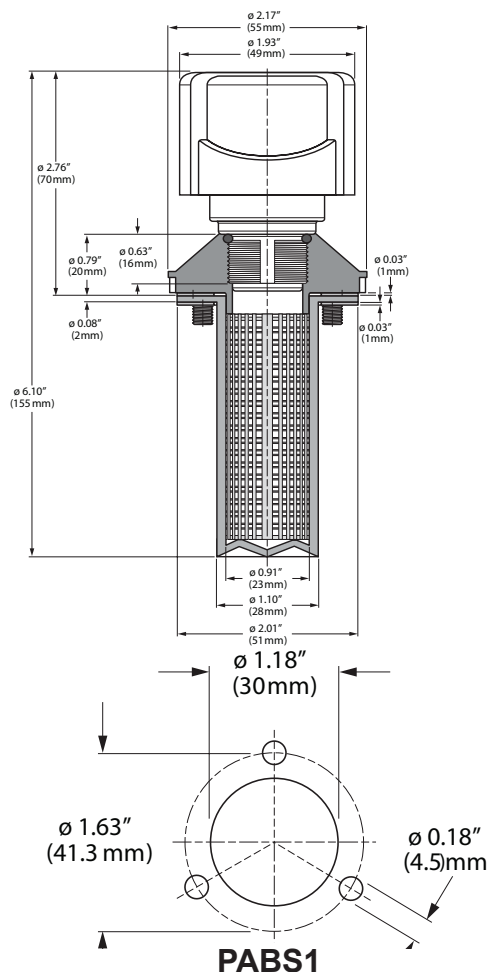

Schroeder
INDUSTRIES

580 West Park Road | Leetsdale, PA 15056
ph. 724.318.1100 | fax 724.318.1200

How to Build a Valid Model Number for a Schroeder PAB1:

BOX 1	BOX 2	BOX 3	BOX 4	BOX 5	BOX 6	BOX 7
<input type="text"/>	<input type="text"/>	<input type="text"/>	<input type="text"/>	<input type="text"/>	<input type="text"/>	<input type="text"/>

Example: Note: Only one option per box

BOX 1	BOX 2	BOX 3	BOX 4	BOX 5	BOX 6	BOX 7	
PAB1	<input type="text"/>	P	3	N	.5	R6	= PAB1P3N.5R6

Model Code for the PAB1:

Box 1	Box 2	Box 3	Box 4	Box 5
Model Number	Replaceable Element	Connection Type	Filtration Rating	Gauge Option
PAB1	OMIT	P - NPT S - SAE	3	N - No Gauge

Box 6	Box 7
Connection Size	Options
.5 - NPT Only 12 - SAE Only	AS - Anti-Splash OMIT- None R6 - 6 PSI Relief Valve R3 - 3 PSI Relief Valve R10 - 10 PSI Relief Valve D - Dipstick

Model Code for the PABS1:

Box 1	Box 2	Box 3	Box 4	Box 5
Model Number	Replaceable Element	Connection Type	Filtration Rating	Gauge Option
PABS1	OMIT	F=Flanged	3	N - No Gauge

Box 6	Box 7
Connection Size	Options
1 - Standard	OMIT - None R6 - 6 PSI Relief Valve R3 - 3 PSI Relief Valve R10 - 10 PSI Relief Valve

* Same day shipment model.
Contact factory for lead time and minimum order quantity for other models.